

Series DM

3 · 5 Port Mechanical Valves

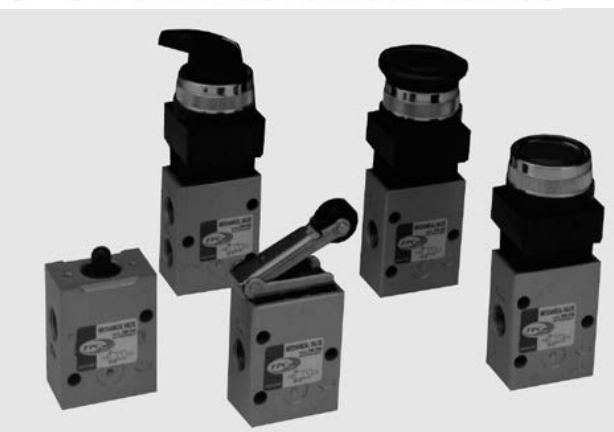

- VARIOUS ACTUATORS AVAILABLE
- EASY TO INTERCHANGE ACTUATOR ASSEMBLIES

How To Order

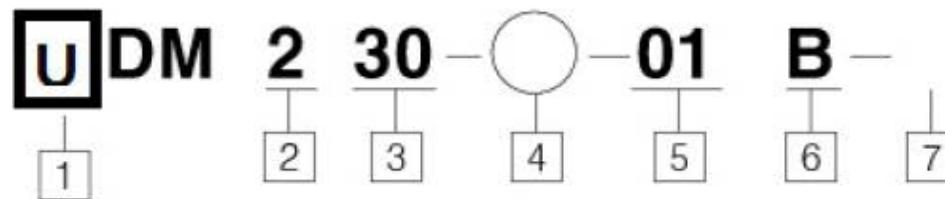

1 Mechanical Valve

Blank : Metric(PT)

U : NPT

2 Body Type / Size

2 : B Type

3 : C Type

4 : D Type

5 : E Type

3 Type of Actuation

30 : 2 Position 3 Port N.O/N.C.

50 : 2 Position 5 Port

4 Mounting

Blank : Standard

*B : Bracket

*Bracket Part No

DM450 Series : DM-4B

DM550 Series : DM-5B

5 Port Size

01 : 1/8

02 : 1/4

6 Actuator

B : Basic Type

R : Roller Plunger

RB : Roller Bearing Type

E : Push Button(Mushroom)

R2 : One Way Roller

RB2 : One Way Roller Bearing Type

P : Push Button(Flush)

S : Selector

7 Actuator's Color(switch)

Blank : Red

G : Green

B : Black

		inch(mm)	
B TYPE	C TYPE	D TYPE	E TYPE
3 Ways		5 Ways	

Series **DH**

Hand Valve (4 way)



- PORTING OF NPT(PT) 1/4 " , 3/8 " AND 1/2 "
- ALUMINUM DIE CASTING DESIGN FOR HEAVY APPLICATIONS
- DETENTED CENTER POSITION

Symbol



How to Order

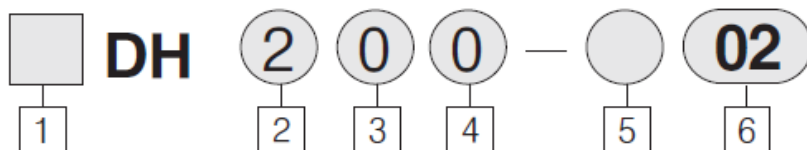

1 Thread

Blank : Rc(PT)

U : NPT

2 Body Size (Basic Size)

2 : Cv 0.4(1/4 " Only)

3 : Cv 1.1(3/8 " Only)

4 : Cv 3.1(1/2 " Only)

3 Piping & Mounting Position

0 : Piping-Side

Mounting-Body

1 : Panel Mountable

4 Position Symbol

0 : 3 Position

Closed Center

2 : 2 Position

5 Thread

Blank : Rc(PT)

G : Rc(PF)

6 Port Size

02 : 1/4

03 : 3/8

04 : 1/2

Model

Series	Port Size Rc(PT)/NPT	Number of Positions	Piping	Model	Effective Orifice in ² (Cv factor)	Weight kgf(lbs)
				Body Ported		
DH2	1/4 "	3(Closed Center)		DH200-02	0.01 (0.4)	0.55(1.21)
UDH2		2Position		DH202-02		
DH3	3/8 "	3(Closed Center)		DH300-03	0.03 (1.1)	0.9(1.98)
UDH3		2Position		DH302-03		
DH4	1/2 "	3(Closed Center)		DH400-04	0.09 (3.1)	1.6(3.53)
UDH4		2Position		DH402-03		

Standard Specifications

Fluid	Air
Proof Pressure	1.5MPa(200 PSI)
Max. Operating Pressure	990kPa(140 PSI)
Ambient and Operating Fluid Temperature	5~60 °C (40~140 °F)
Operating Angle	90 °

Series DP300/3000/5000

3 · 5 Port Air Pilot Valve



- COMPACT SIZE AND LIGHT WEIGHT
 - 0.63 inch Width (Series UDP300, UDP3000)
 - 1.26 inch Width (Series UDP5000)
- LARGE FLOW CAPACITY
 - Cv. 1.0 - NPT 1/4" (Series UDP300,UDP3000)
 - Cv. 3.2 - NPT 1/2" (Series UDP5000)

Symbol

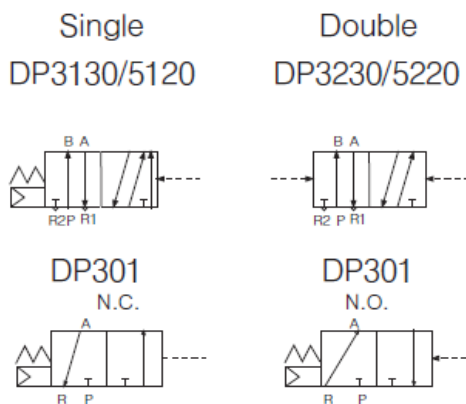

How to Order

DP300

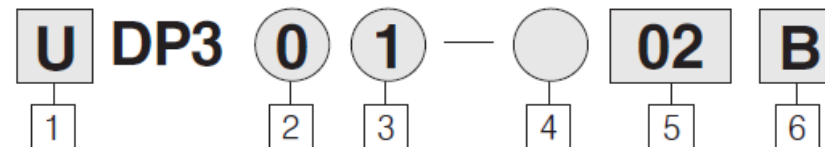

1 Series DP300

Blank : Metric (PT)
U : NPT (UNF)

2 Action

0 : Normally Closed /
Normally Open

3 Body Type

1 : Body Ported

4 Thread

Blank : Rc (PT)
G : Rc (PF)

5 Port size (P, A, R)

01 : 1/8"
02 : 1/4"

6 Body Type

A : N.C.
B : N.O.

※ Exhaust port is only 1/8"

DP3000

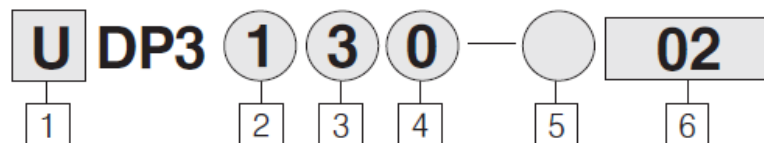

1 Series DP3000

Blank : Metric (PT)
U : NPT (UNF)

2 Configuration

1 : Single Pilot type
2 : Double Pilot type

3 Body Type

3 : For 30 type Manifold
(Body Ported)

4 Body Specifications

0 : Standard

5 Thread

Blank : Rc (PT)
G : Rc (PF)

6 Port Size (P, A, B)

01 : 1/8"
02 : 1/4"
※ Exhaust Port is only 1/8"

DP5000

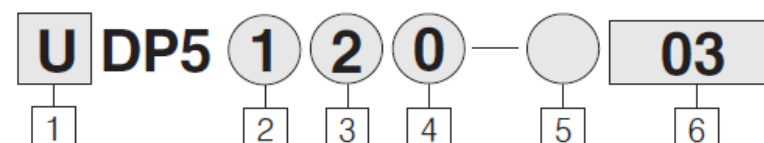

1 Series DP5000

Blank : Metric (PT)
U : NPT (UNF)

2 Configuration

1 : Single pilot type
2 : Double pilot type

3 Body Type

2 : For 20 type Manifold
(Body Ported)

4 Body Specifications

0 : Standard

5 Thread

Blank : Rc (PT)
G : Rc (PF)

6 Port Size (P, A, B)

03 : 3/8"
04 : 1/2"
※ Exhaust Port is only 1/8"

Series DT220

OR Valve (Shuttle Valve)



- 3 PORT OR VALVE WITH OUTPUT AND 2 PNEUMATIC SIGNAL INPUT PORT

Symbol

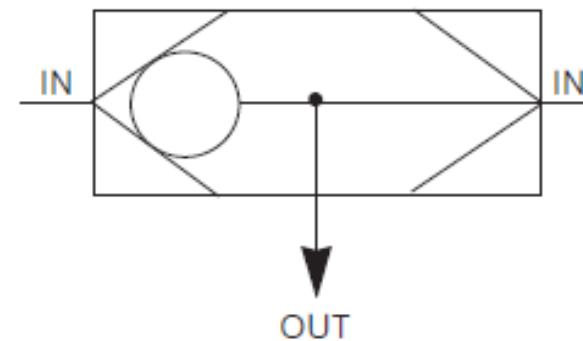

Model/Specification

Model	DT 220-02
Port Size	Rc(PT)1/4
Max. Operating Pressure	9.9 kgf/cm ²
Min. Operating Pressure	0.5 kgf/cm ²
Ambient and Fluid Temperature	0~60 °C
Effectine Area (Cv)	19mm ² (1.0)
Using pressure difference between high and low pressure on "IN" side.	Minimum 0.5kgf/cm ²

Dimensions

(Unit : mm)

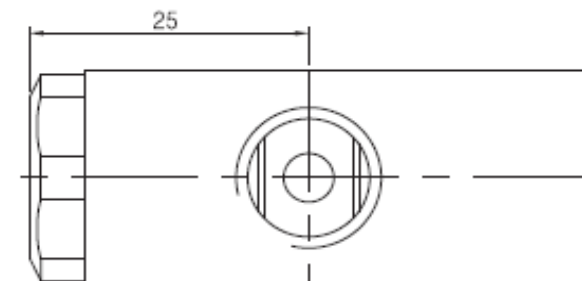
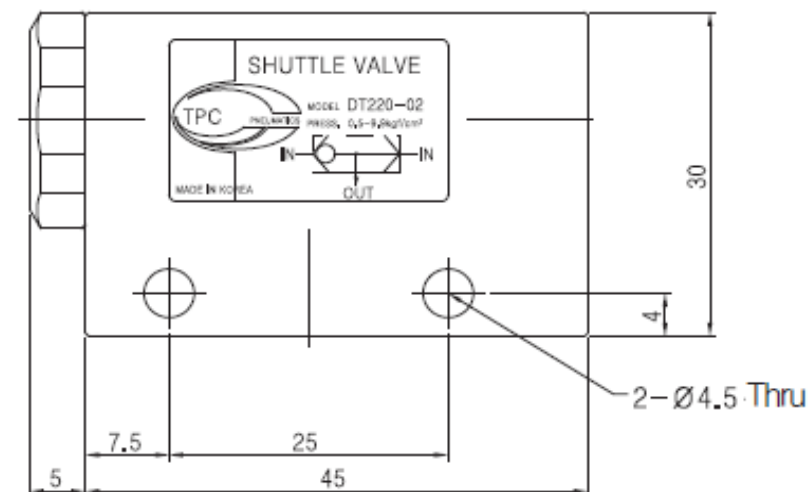
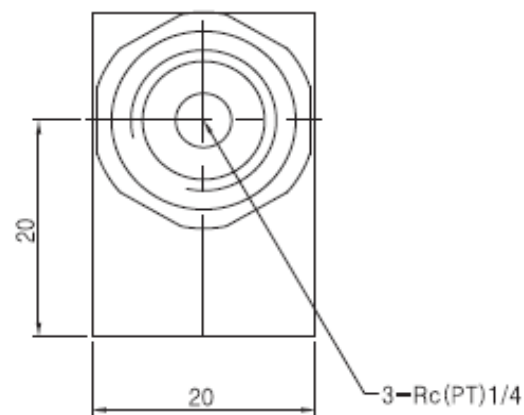

High-speed exhaust valve

Series DQE



- Mass flow volume structure of compact size
- By special shape processing of L valve body, secure maximum rate of flow compared to similar model.
- Minimized the flow volume loss through shaping a flow path in check packing (DQE5000)
- Implemented a perfect sealing function through adoption of check packing structure
- Equipped with diverse pipe bore, screw size and option

How to Order

DQE 2000 — 01 U

1 2 3

1 Body Size

Item no.	SIZE
2000	DQE2000 SERIES
3000	DQE3000 SERIES
5000	DQE5000 SERIES

3 Connection specification of port screw

Item no.	TAP Description
No symbol	Rc(PT)
U	NPT

2 Bore Size

Item no.	IN, OUT PORT	EXHAUST PORT	Remarks
01	Rc(PT)1/8	Rc(PT)1/4	2000 SERIES
02	Rc(PT)1/4		
03	Rc(PT)3/8	Rc(PT)1/2	3000 SERIES
04	Rc(PT)1/2		
04	Rc(PT)1/2	Rc(PT)3/4	5000 SERIES
06	Rc(PT)3/4		